

December  
2017



KOKA

英語版広報 こうか 12月号



## December Information

### Account Transfer for Taxes & Fees

(こうぎ ふりかえ)

Account transfer for city taxes and fees is recommended because it is convenient, safe and reliable.

**Convenient:** you will not have to visit the City Hall or financial institutions for payments. Once you set up an account transfer for payments, you will not have to set it up again for a new fiscal year.

**Safe:** you will not have to carry cash.

**Reliable:** you will not forget to pay taxes and fees. Further, you can check your payment records with bankbook thus not have to worry about misplacing receipts.

**Setting up an account transfer:** Complete the designated account transfer application form at a financial institution. After stamping your seal, submit the form to the financial institution where you would like to set up the account transfer. Transfer will take place from the following month.

**Accepting financial institution:** Shiga Bank (しが ぎんこう), Kansai Urban Bank (かんさい あーばん ぎんこう), Koka Nogyo Kyodo Kumiai (こうか のうぎょう きょうどう くみあい), Koto Shinyo Kinko (ことう しんよう きんこ), Shigaken Shinyo Kumiai (しがけん しんよう くみあい), Kyoto Bank (きょうと ぎんこう), Kinki Rodo Kinko (きんき ろうどう きんこ), Green Omi Nogyo Kyodo Kumiai (ぐりーん おうみ のうぎょう きょうどう くみあい), Shigakenmin Shinyo Kumiai (しがけんみん しんよう くみあい), Japan Post Bank (ゆうちょ ぎんこう).

Inquiry: Zeimu Ka at phone: 0748-69-2130 FAX: 0748-63-4574

### City Housing Available

(しえいじゅうたく)

City housing is available for application.

**Application period:** December 1st (Fri) to 12th (Tue)

**Application:** Starting December 1st, details and instructions regarding Application process is available at Jutaku Kenchiku Ka at Koka City Hall. Details are also available from Koka City homepage. Complete the designated form and submit it to Jutaku Kenchiku Ka.

Inquiry: Jutaku Kenchiku Ka at phone: 0748-69-2212 FAX: 0748-63-4601

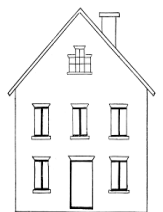

# International Festival in Koka



The biggest international festival in Koka City will be held on December 17 (Sun). This festival will be a great opportunity to enjoy international exchanges, as many international food booths and hands-on activities will be available.

**Date & Location:** December 17th (Sun) from 11:00am to 4:00pm at Hekisui Hall in Minakuchi.

**Fees:** FREE admission (beverages and foods are paid in cash directly at each booth).

**Inquiry:** Koka International Society at 0748-63-8728.

## HEALTH CHECKUP FOR INFANTS AND TODDLERS

### DECEMBER

がつにゆうよう じけんしん

### 12月 乳 幼児健診

No appointment required: visit your nearest Hoken Center directly. For more details, refer to Health Checkup Calendar. Inquiry: すこやか支援課 (すこやか しえんか) at 0748-69-2168

| Health Checkup       | Eligible Child | Exam Date   | Location     | Reception Hours   | Items to Bring   |
|----------------------|----------------|-------------|--------------|-------------------|--|
| 4 months             | August 2017    | 12/13 (Wed) | Koka HC      | 1:00pm~<br>1:30pm | Maternity record book(ぼしてちょう), questionnaire (しつもんひょう), towel, diapers, change of clothes, formula if necessary.             |
|                      |                | 12/21 (Thr) | Minakuchi HC |                   |  |
| 10 months            | January 2017   | 12/13 (Wed) | Koka HC      | 1:00pm~<br>1:30pm | Maternity record book(ぼしてちょう), questionnaire (しつもんひょう), towel, diapers, change of clothes, formula if necessary.             |
|                      |                | 12/14 (Thr) | Minakuchi HC |                   |  |
| 1 year and 8 months  | April 2016     | 12/1 (Fri)  | Koka HC      | 1:00pm~<br>1:30pm | Maternity record book(ぼしてちょう), questionnaire (しつもんひょう), diapers  |
|                      |                | 12/6 (Wed)  | Minakuchi HC |                   |  |
| 2 years and 6 months | May 2015       | 12/1 (Fri)  | Koka HC      | 1:00pm~<br>1:30pm | Maternity record book(ぼしてちょう), questionnaire (しつもんひょう), survey for your child's hearing ability (ささやきこえけんしん)                 |
|                      |                | 12/11 (Mon) | Minakuchi HC |                   |  |
| 3 years and 6 months | May 2014       | 12/7 (Thr)  | Koka HC      | 1:00pm~<br>1:30pm | Maternity record book(ぼしてちょう), questionnaire (しつもんひょう), Additional questionnaire distributed at 2 years and 6 months checkup |
|                      |                | 12/18 (Mon) | Minakuchi HC |                   |  |

### December Taxes (12がつの ぜいきん)

- Fixed property tax 固定資産税 (こていしさんぜい)
- Nursing Care Insurance 介護保険料 (かいごほけんりょう)
- National Health Insurance Tax 国民健康保険税(こくみんけんこうほけんぜい)
- Latter-stage elderly medical insurance fees 後期高齢者医療保険 (こうきこうれいしゃいりょうほけんりょう)
- Nursery school fee 保育料 (ほいくりょう) ● Kindergarten fee 幼稚園使用料 (ようちえんしょうりょう)
- Water fee 水道料金 (すいどうりょうきん)

English interpreter is available from 8:30 a.m. to 5:15 p.m.  
Phone: 0748-69-2114

Automated translation is available  
on our homepage:  
<http://www.city.koka.lg.jp/>